



# trace r&d | 2009

## Diamond/Diamant

Canada 

## Platinum/Platine



## Gold/Or

Manitoba 

 Ontario



## Silver/Argent

Alberta

IBM<sup>®</sup>

 ManitobaPork

CANADIAN  
**Cattlemen**  
THE • BEEF • MAGAZINE

## Bronze/Bronze

Alberta Farmer Express  
Canadian Poultry Magazine  
Canadian Wheat Board /  
Commission Canadienne du blé

Consumer & Marketing Demand Network  
Gallagher Canada  
Grainnews  
Intelliware Development Inc.

Manitoba Co-operator  
On Trace  
Trace it Solutions

4  
8  
4  
4  
2  
7  
9  
3  
3  
5  
3  
8  
0  
2  
9  
6  
7  
4  
6  
5  
9  
9  
4  
6  
7  
8  
0

# Agri-food Traceability Solution

Presented by : *Grégory Pétrieux*

EPSILIA



*Trace R&D 2009 – Winnipeg, Manitoba*

# Epsilia's Expertise

Powered by  
**EPSILIA**

- Specialist in traceability for standardized markets
  - Agri-food
  - Transportation
  - Manufacturing
- Specialist in RFID and wireless technologies
- Ten years of experience in traceability software R&D and implementation. Hundreds of projects deployed in Canada, Europe and USA



***Trace R&D 2009 – Winnipeg, Manitoba 3***

4  
8  
4  
4  
2  
7  
9  
3  
5  
3  
8  
0  
2  
9  
6  
7  
4  
6  
5  
9  
9  
4  
6  
7  
8  
0

# Epsilia's Expertise



- Member of GS1 Traceability sub-Committee for the adoption of global standards-based supply chain traceability for food and consumer products
- Integrated solution with government agencies and specific market's associations or federations
- Motorola's partnership
- Annual volume used by our solution
  - Bovine, ovine : 1 million head
  - Porcine : 2 million head
  - Poultry : 15 million head



# Traceability solution

Linked to the Trace it global solution, eTrace is the traceability system that tracks in real time all the information during the processing of transformation. This solution manages movements (material and human resources) and conditions (production), from raw materials (animals) to finished products throughout the agri-food logistic chain.



9  
4  
6  
7  
8  
0

# Diagram – Complete Traceability solution

Powered by  
EPSILIA  
E TRACE



**Slaughtering**  
1<sup>st</sup> transformation



**RFID animals**  
identification



**Receiving process**



Carcasses  
raw materials

5  
3  
9  
7  
2  
4  
8  
4

# Modules



- Traceability system manager
- RFID animals identification
- Slaughtering management
- Primal Cut management (input/output ratio)
- Data Collection
- Receiving
- Production
- Shipping
- Quality Assurance (sampling, quarantined product)
- Labelling (UPC code, nutritive value, allergen, etc.)
- RFID Manager
- Transportation Management (Trafik)
- Access Management (Trafik)
- Delivery optimization and monitoring (GPS)



# Benefits of the software solution



- Reduce costs in relation to recall management
- Reaction time : less than 4 hours – typically 20 minutes
- Increase the security in the Agrifood sector
- Increase productivity and reduce manual operations
  - Access in real time to relevant data
  - Reduce data entry and minimise risks of errors
  - Allow an efficient management of logistic operations



# Benefits of the software solution



- Ensure reliable information exchange with financial systems
- Improve reporting, analysis, and quality assurance monitoring.
- Inventories and warehouses management improvement
- Facilitate audits and traceability processes



4  
8  
4  
4  
2  
7  
9  
3  
3  
5  
3  
8  
0  
2  
9  
6  
6  
4  
7  
6  
9  
9  
4  
6  
7  
8  
0

# Hardware used in our solution

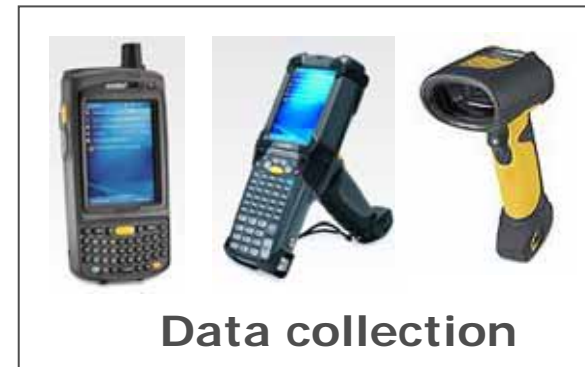



# Diagram – RFID Slaughtering Plant

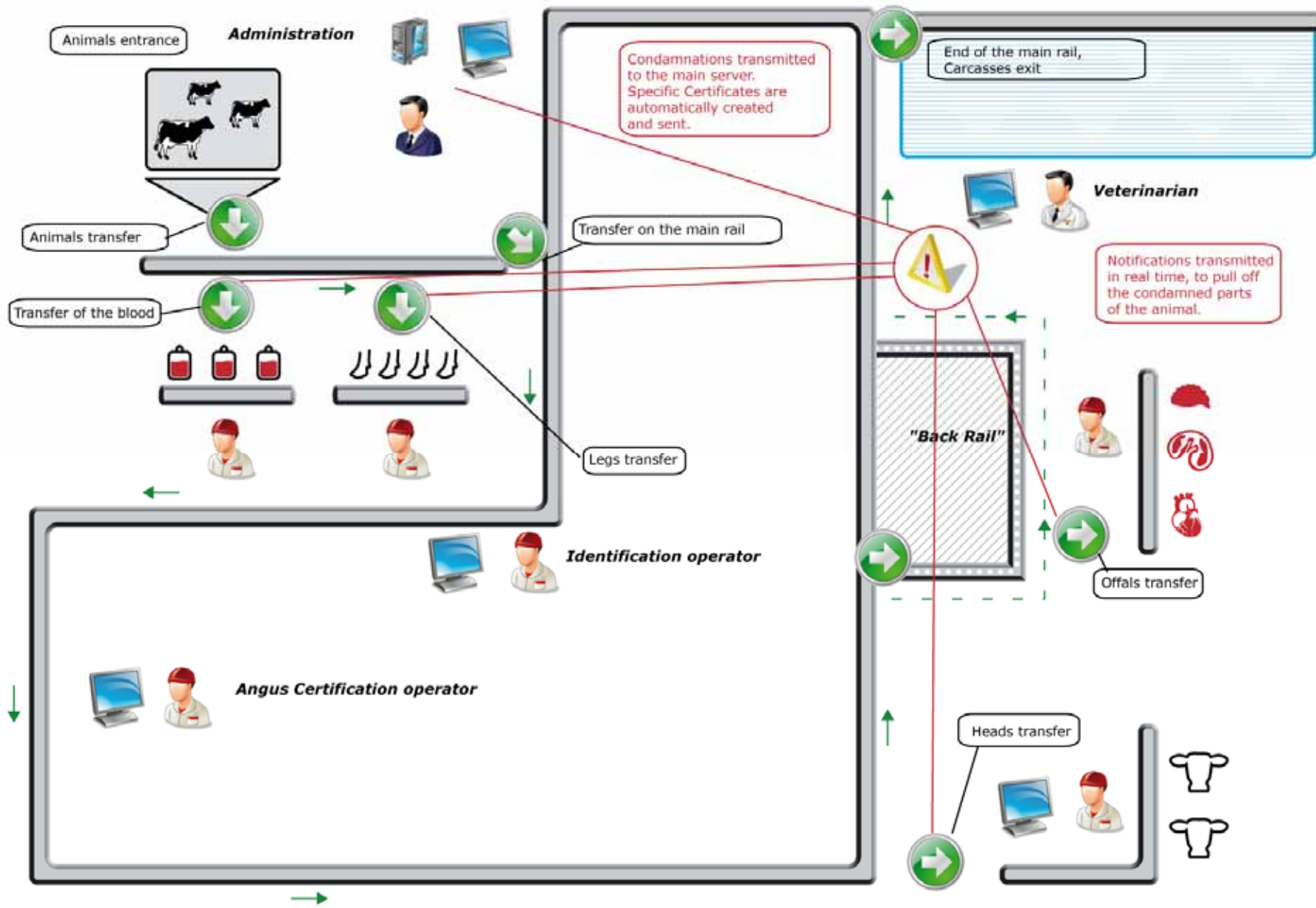

4  
6  
7  
8  
0  
2  
3  
3  
5  
5  
7  
7  
8  
8  
9  
9  
9  
4  
6  
7  
8  
0

# RFID Slaughtering Solution

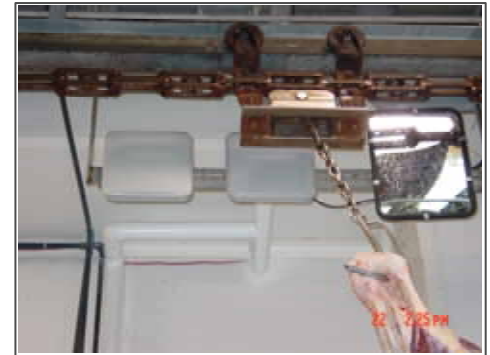
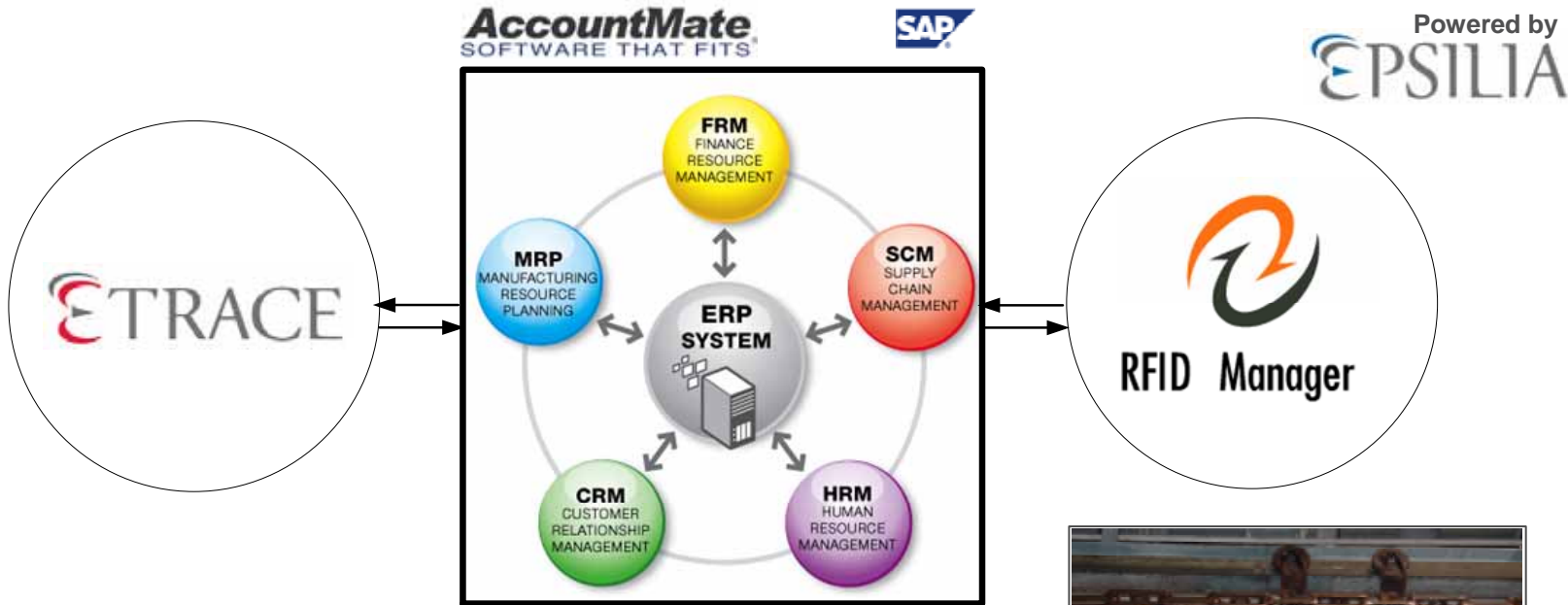

4  
8  
4  
2  
7  
9  
3  
5  
3  
8  
0  
2  
9  
6  
7  
4  
6  
5  
9  
9  
4  
6  
7  
8  
0

# RFID Slaughtering Solution

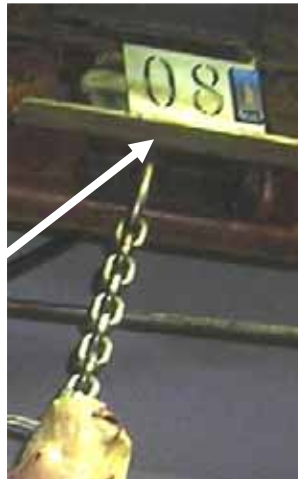

*Trace R&D 2009 – Winnipeg, Manitoba*

4  
6  
7  
8  
0  
4  
8  
4  
4  
2  
7  
9  
3  
5  
3  
8  
0  
2  
9  
6  
6  
7  
4  
6  
5  
9  
9

# RFID Slaughtering Solution

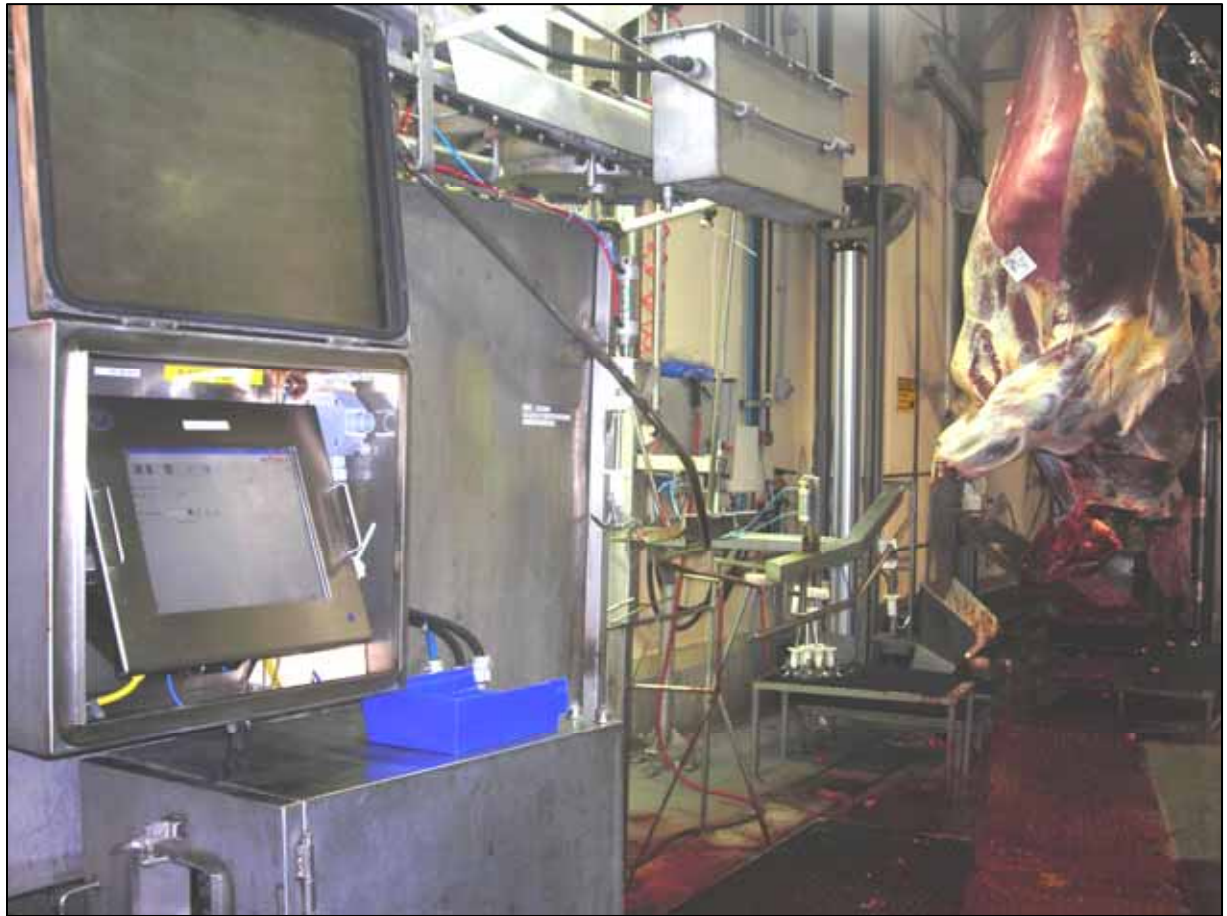

# Slaughtering Solution - Functionalities

## Value added functionalities



- Manages slaughtering batches
- Manages animals from a batch
- Manages condemnation, reserves or others
- Manages carriers
- Manages the source of the animals
- Tracks & traces slaughtering batches
- Angus Certification (photos – videos)
- Certification of the age of the animal
- Produces and transfer automatically the declarations to government agencies



# Slaughtering Solution - Functionalities



## Specialized Reports

- Slaughtering report and ratio
- Synopsis of slaughtering
- Detail of the batches
- Report and ratio for Government Agencies
- Certificate of condemnation
- Certificate of euthanasia
- Etc...Customizable reports



# Benefits - RFID Slaughtering Solution

- Ensuring precise product traceability
- Achieving ROI in less than one year by increasing process and staffing efficiency
- Increasing revenue by as much as 25 percent by enabling penetration of new international markets
- Providing real-time data to support effective management decisions



*Trace R&D 2009 – Winnipeg, Manito*  Powered by

Thank you!

## Contact information



### Trois-Rivières - Head Office

1350, Royale, #300  
Trois-Rivières (Quebec) CANADA G9A 4J4



### Montreal Office

205, Viger, #110  
Montreal (Quebec) CANADA H2Y 1G2

[www.epsilia.com](http://www.epsilia.com)

